

Convene Sancroft, St. Paul's

Rose Street, Paternoster Square, London EC4M 7DQ

MEETINGS & EVENTS



Nestled between historic London landmarks in Paternoster Square, Convene Sancroft, St. Paul's is a one-of-a-kind venue with impressive scale. The location spans 45,000 square-feet across two floors and features a total of seven unique meeting rooms - including a 850-person plenary room, the largest single above-ground event space in City of London - and can accommodate a total of 1,200 guests.

The design of the space draws inspiration from the surrounding local craftsmanship and nearby contemporary architecture boasting a neutral backdrop that contrasts the bold interior design elements intended as a nod to the Elizabethan Era, including vibrant pops of rich color, textured wall panelings, and intricate ceilings. The location is flooded with natural light from the nine-foot floor-to-ceiling windows and provides a white box space allowing for client and event branding opportunities, in-house catering with customisation options and dining private to each event, in-room A/V technology supported by an on-site team, and dedicated hospitality resources.

The location is easily accessible via public transport and is in close proximity to the London Stock Exchange.

45,000

TOTAL SQUARE FEET

1,200

FULL BUYOUT CAPACITY

7

MEETING ROOMS



HIGH SPEED
WIFI



STATE OF THE ART
TECHNOLOGY



FLEXIBLE MEETING
& EVENT SPACE



EVENT PLANNING
SERVICES



ON-SITE
GOURMET CHEF



UNLIMITED ON-SITE
DRINKS & SNACKS



This collateral is based on the latest information reasonably available and may be updated on a periodic basis. Please check with your Convene Account Manager for the latest information.

convene
CONVENE.COM | +44 (0)80 0640 6630

Floorplan & capacities

LEVEL 1

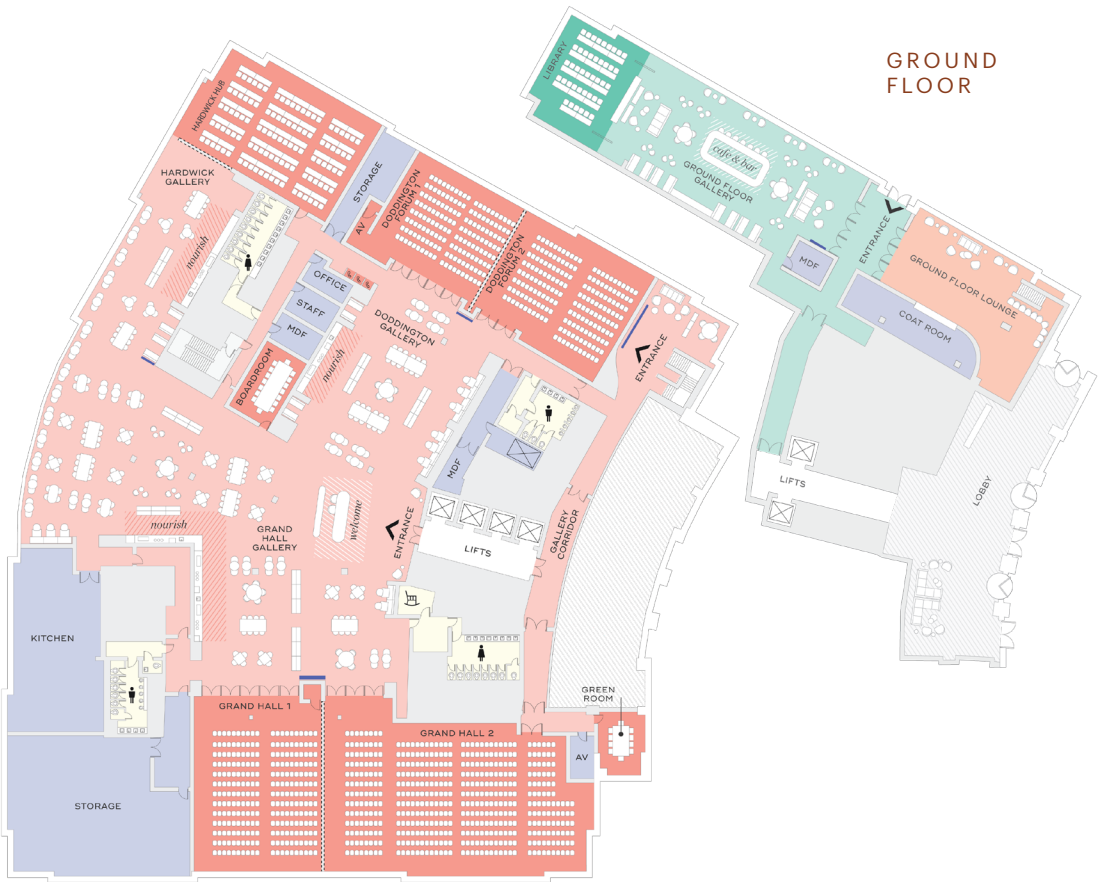
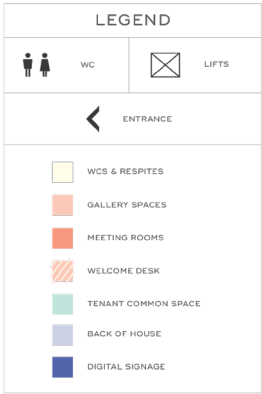

	AREA SQ FEET	AREA SQ METRES	RECEPTION (MAX CAPACITY)	THEATRE	CLASSROOM	CRESCENT CABARET	DINING	U-SHAPE	ROUNDS
Tradition Library	1,044 ft ²	97 m ²	50	96	36	60	70	27	60
Ground Floor Gallery	3,170 ft ²	291 m ²	-	-	-	-	-	-	-
Ground Floor Lounge	1,392 ft ²	128 m ²	-	-	-	-	-	-	-
Grand Hall	6,964 ft ²	644 m ²	-	850	312	444	410	120	310
Grand Hall 1	2,524 ft ²	235 m ²	-	242	144	144	-	54	120
Grand Hall 2	4,381 ft ²	407 m ²	-	442	186	276	-	66	190
Grand Hall Gallery	3,950 ft ²	367 m ²	900	-	-	-	-	-	-
Doddington Forum	3,434 ft ²	319 m ²	-	340	129	192	280	63	160
Doddington Forum 1	1,574 ft ²	146 m ²	-	173	70	96	-	39	80
Doddington Forum 2	1,824 ft ²	188 m ²	-	154	51	96	-	33	80
Doddington Gallery	4,015 ft ²	373 m ²	-	-	-	-	-	-	-
Hardwick Hub	2,199 ft ²	203 m ²	-	240	66	144	140	48	130
Hardwick Gallery	2,092 ft ²	193 m ²	-	-	-	-	-	-	-